



- **2,546** RSF
- **\$15.35** / RSF / YR



- Full Service
- First floor - entry in lobby
- **Signage on Douglas**



- **6 Offices**, Conference Room, Reception Area, & Kitchenette



- **Parking included** in rate for tenants and visitors



## 200 W. Douglas, Suite 101

### Office Space | OW Garvey Building

#### Floor Plan

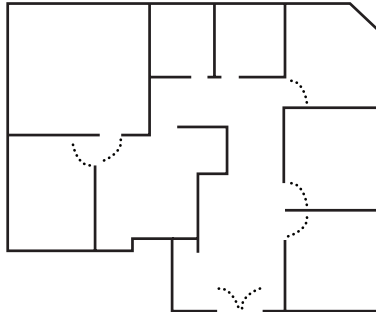

To schedule a tour, email: [larry@garveycenter.com](mailto:larry@garveycenter.com)

250 Douglas Place #100, Wichita KS 67202  
(316) 261-5325 • [garveycenter.com](http://garveycenter.com)

Visit our website for a complete listing of available spaces





# Garvey Center Amenities

- **Access to the rooftop pool, pickleball & basketball courts, golf driving range & more!**
- **On-site restaurants** for a variety of quick lunch options, plus 24-hour snack vending and Micro Market
- **FREE 24-hour fitness facilities**
- **After hours keyed access** with ring down phone access
- **Professional** management staff & 24-hour **emergency** maintenance staff
- Conference rooms with seating for **8-40 people** available to tenants at **no charge**

Visit our website for a complete listing of available spaces:  
[garveycenter.com](http://garveycenter.com)

To schedule a tour, email:  
[larry@garveycenter.com](mailto:larry@garveycenter.com)